

KIT PER / FOR RM 40

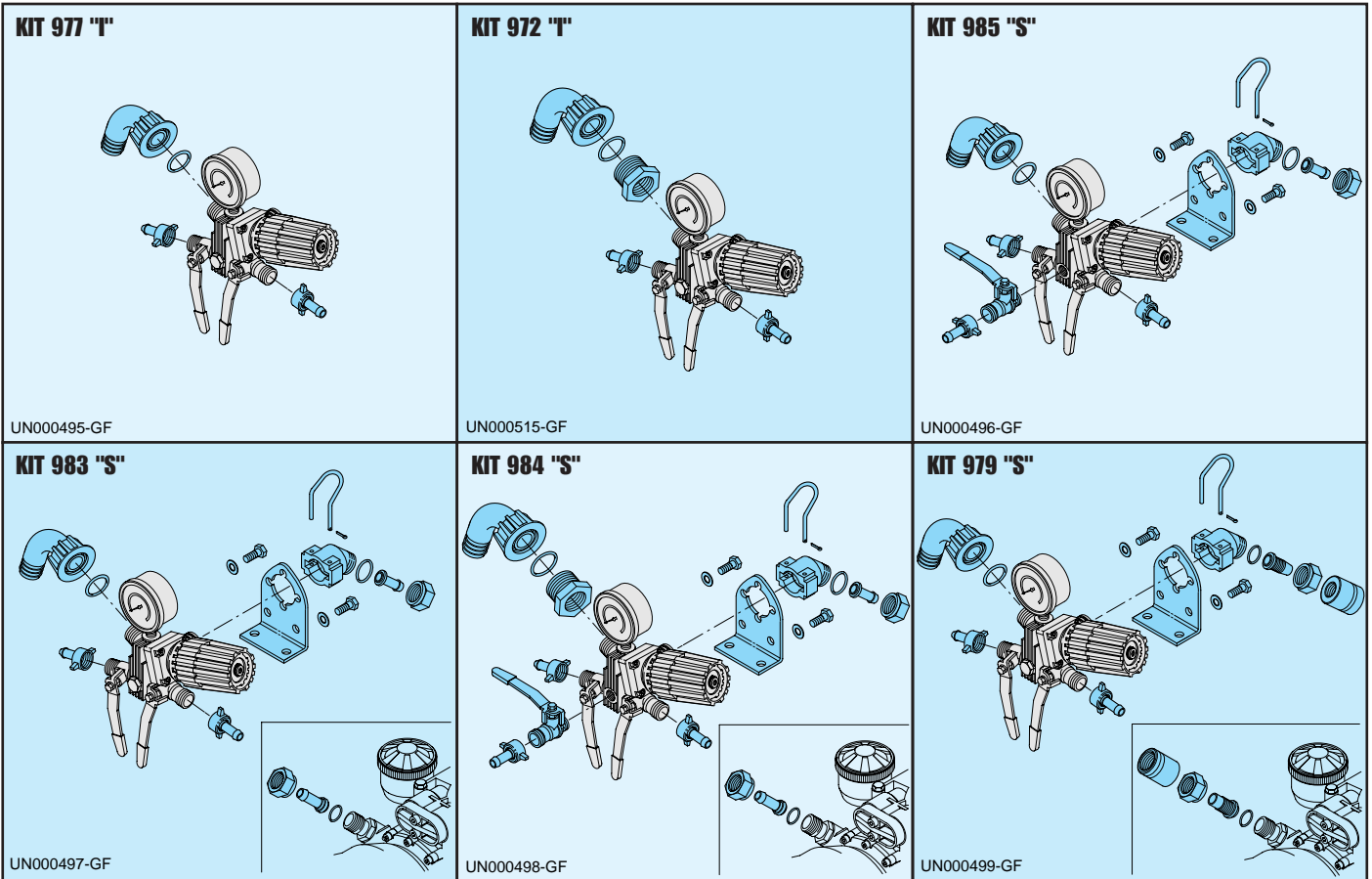

Pos.	Cod.	Descrizione	Description	Q.ty	Note
1	550460	Curva ø 18	Elbow	1	
2	800340	Portagomma ø 20	Hose tail	1	Optional
	800342	Portagomma ø 16	Hose tail	1	Optional
3	550450	Girello 3/4" G	Ring nut	1	
4	390180	OR ø 18,72x2,62	O-Ring	4	
5	550545	Manometro ø 63	Pressure gauge	1	0-80 bar
6	1040690	Forcella	Fork	1	
9	1150520	Sede valvola	Valve seat	1	
10	680560	Vite TCEI M 6x16	Bolt	1	
11	1040640	Valvola inox	Valve	1	
12	1040630	Membranina	Diaphragm	1	Desmopan
	1040631	Membranina	Diaphragm	1	Gomma
13	880830	OR ø 15,54x2,62	O-Ring	4	
14	1040620	Pistone	Piston	1	
15	1150560	Distanziale molla	Spring spacer	1	
16	1150600	Rullino	Roller	2	
17	1150540	Perno	Pin	1	
18	1150510	Corpo superiore	Upper body	1	
20	780330	Vite TCEI M 6x20	Bolt	4	
21	1150530	Frontale	Plate	1	
22	394760	Molla	Spring	1	
23	1150550	Manopola rossa	Adjustment knob	1	
24	1150570	Ghiera carica molla	Ring nut	2	
26	130491	Rub. 3/8"-1/2" G (M) DX	Right valve	1	ex 30491
27	130171	Tappo 3/8"G	Plug	1	ex 30171
28	1150500	Corpo valvola	Valve body	1	
29	1150590	Staffa	Bracket	1	
30	390311	Rosetta øi 8,5	Washer	2	
31	180431	Vite TE M 8x16	Bolt	2	
32	1040770	Attacco 3/4" G (M)	Coupling	1	
34	1040790	Girello raccordo 3/4"G	Nut	2	
35	1150580	Portagomma ø 13	Hose tail	2	
36	1040760	Attacco 3/4" G	Coupling	1	
37	480550	Anello seeger	Circlip	1	

Pos.	Cod.	Descrizione	Description	Q.ty	Note
38	1150650	Vite TCTC M 3x60	Screw	1	
39	110131	Racc.1/2"G+ tub. ø10	Fitting 1/2" G+hose ø10	3	ex 10131
40	1150660	Distanziale molla	Spring spacer	1	
41	130492	Rub. 3/8"-1/2" G (M) SX	Left valve	1	ex 30492
42	1040950	Copiglia	Split pin	1	
43	550370	Curva ø 25	Elbow	1	
44	550242	Girello 1" G	Ring nut	1	
45	550350	OR ø 23,81x2,62	O-Ring	1	
46	800720	Niples 3/4"G(F)-1"G(M)	Threaded adapter	1	
47	960160	OR ø 17,86x2,62	O-Ring	2	
48	1040810	Portagomma ø 13x24	Hose tail	2	
49	1040800	Ghiera raccordo	Ring nut	2	
50	110130	Racc.1/2" G+tub. ø13	Fitting 1/2" G+hose ø13	1	
51	450145	Flangia raccordo	Flange	1	

○ Non compreso nel RM 40 - No part of RM 40

● Compreso nella pompa - Part of pump

KIT 1988 OR O-Ring				KIT 1989 Pronto intervento Maintenance repair			
Pos.	Q.ty	Pos.	Q.ty	Pos.	Q.ty	Pos.	Q.ty
4	2			4	2	22	1
13	4			6	1	23	1
				9	1	24	1
				11	1	37	1
				12	1	38	1
				13	4	40	1
				15	1	42	1
				17	1		
				21	1		

Comando incorporato e separato / Build-in control unit and remote control

KIT 977 "I" Comando incorporato Build in control				Per / for AR 503
Pos.	Q.ty	Pos.	Q.ty	
1	1			
3	1			
13	1			
39	2			

KIT 972 "I" Comando incorporato Build in control				Per / for AR 713 AR 813
Pos.	Q.ty	Pos.	Q.ty	
39	2			
43	1			
44	1			
45	1			
46	1			

KIT 985 "S" Comando separato Remote control				Per / for AR 30 AR 50
Pos.	Q.ty	Pos.	Q.ty	
1	1	39	3	
3	1	42	1	
6	1			
13	2			
26	1			
29	1			
30	2			
31	2			
32	1			
34	1			
35	1			

KIT 983 "S" Comando separato Remote control				Per / for AR 503
Pos.	Q.ty	Pos.	Q.ty	
1	1	42	1	
3	1			
6	1			
13	3			
29	1			
30	2			
31	2			
32	1			
34	2			
35	2			
39	2			

KIT 984 "S" Comando separato Remote control				Per / for AR 503 AR 713 AR 813
Pos.	Q.ty	Pos.	Q.ty	
6	1	43	1	
13	2	44	1	
26	1	45	1	
29	1	46	1	
30	2			
31	2			
32	1			
34	2			
35	2			
39	3			
42	1			

KIT 979 "S" Comando separato Remote control				Per / for AR 503 AR 713 AR 813
Pos.	Q.ty	Pos.	Q.ty	
1	1	47	2	
3	1	48	2	
6	1	49	2	
13	1			
29	1			
30	2			
31	2			
32	1			
34	2			
39	2			
42	1			