

A333072

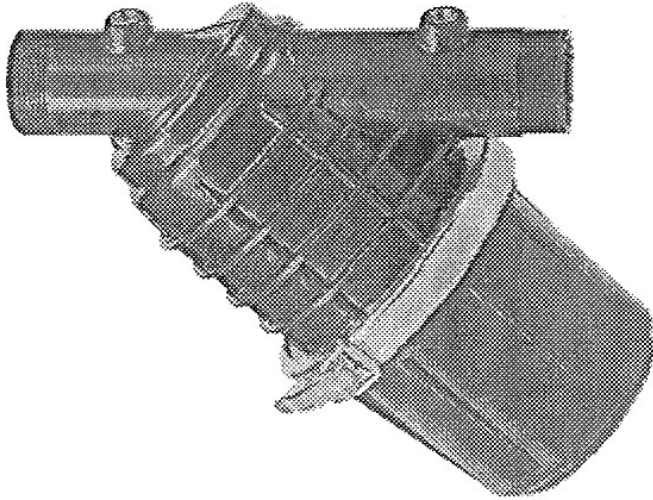

- 2" screen filters series 333**
- 2" BSP threads
 - Filtering capacity 380 l/min (100 US. GPM)
 - Cartridge Ø 107 x 286 mm
 - Polypropylene body, EPDM gaskets
 - Working pressure 8 bar max (116 PSI max)
 - Bleed thread 3/4" BSP (open)

Polypropylene cartridge frame

| COD. | F (BSP) | Rete Screen | | area area | | area effettiva effective area | |
|---------|---------|-------------|------|-----------------|--------|-------------------------------|--------|
| | | Type | mesh | cm ² | sq. in | cm ² | sq. in |
| 333 072 | G 2 | Inox | 32 | 531 | 82.3 | 294 | 45,5 |

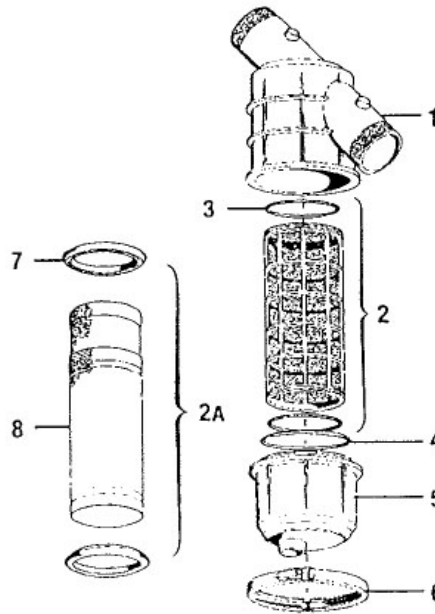

| Position | Part Number | Description |
|----------|--------------|----------------------------------|
| 1 | A333070.010 | Inline filter body (A333 series) |
| 2 | A317002.030 | 32 mesh filter element |
| 2 | A317003.030 | 50 mesh filter element |
| 2 | A3170035.030 | 80 mesh filter element |
| 2 | A317004.030 | 100 mesh filter element |
| 3 | A316300.060 | O-Ring for filter element |
| 4 | A333000.050 | O-Ring for filter bowl |
| 5 | A333000.020 | Filter Bowl |
| 6 | A333000.040 | Filter locking clamp |